

METALMASTER



Operation and Maintenance Manual

Chip / Sludge Removal Machine

MMC-SVAC

Order Code: (W2741)

MMC-SVAC

Chip / Sludge Removal Machine

Table of Contents

01 Precautions and disclaimer prior to use
-----01

02 Standard Package and Accessories
-----01

03 Equipment Specification and Appearance
-----02

04 Installation Steps
-----03 ~ 05

05 Filter Bucket Maintenance
-----06 ~ 07

06 Pneumatic Pump Maintenance & Replacement
-----08

07 Warranty
-----09

MMC-SVAC

Chip / Sludge Removal Machine

Precautions and disclaimers prior to the use

When installing this product, please note the following.

1. Before installation, ensure that there are no corrosive solvents in the cutting fluid of the water tank to prevent damage to the machine.
2. Please make sure the machine is in a non-operational state before performing inspection, adjustment, or cleaning procedures.

Standard Package and Accessories

Outer Package



Inside package



Accessories

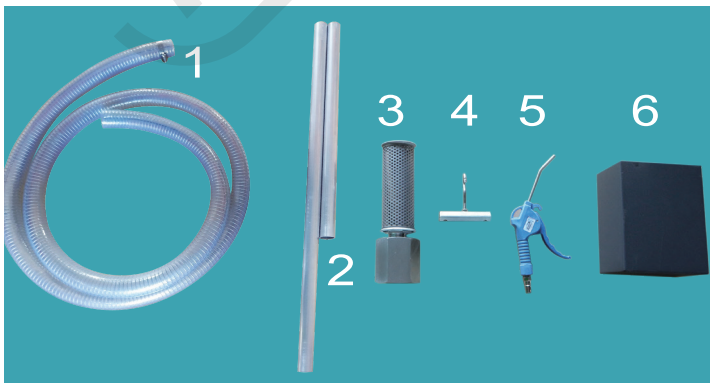

1. Suction Hose
2. Aluminum Suction Pipes (Long & Short)
3. Suction pickup & counterweight
4. Filter Bucket Hook
5. Air Gun
6. Drip collection bucket

MMC-SVAC

Chip / Sludge Removal Machine

Equipment Specification and Appearance



Specifications table

Model	MMC-SVAC
Net weight	56kg
Size	420*600*900 mm
Filter capacity	12 L
Maximum Pump Capacity	180Liters/per min Measuring with water
Air Pressure	0.5 Bar-8.3 Bar (7.25Psi-120 Psi)
Filtration Accuracy- Standard Mesh	380um (40mesh)
Filtration Accuracy- Optional	830um(20mesh) 、180um(80mesh)
Filter Material	304 stainless steel



1. Connect the counterweight and the outlet to suction filter to the side of the outlet hose that has the hose clamp on, and tighten them securely by hand.



2. Connect the end of the inlet hose that does not have a hose clamp to the black hose gland.

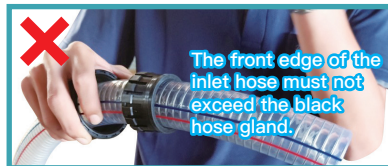

3. Insert the inlet hose (the side without the hose clamp) into the black hose gland, ensuring that the front edge of the hose aligns with the front edge of the black hose gland.

MMC-SVAC

Chip / Sludge Removal Machine

Installation Steps



4.

Tighten the pipe by hand.



5.

Connect the other end of the inlet hose to the aluminum pipe (short), and tighten the screw of the hose clamp.

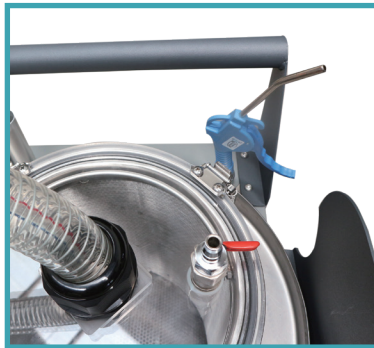

6.

Connect the air gun.

MMC-SVAC

Chip / Sludge Removal Machine

Installation Steps



7.
Install the leakage collector.

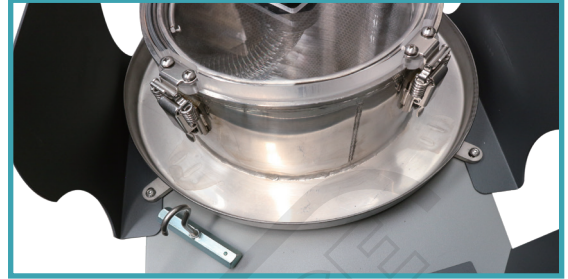

8. The filter bucket hook can be placed anywhere on the machine.

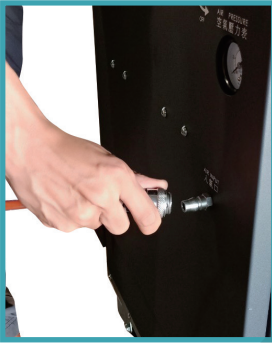

9.
After connecting the air compressor hose, you will be able to turn on the pneumatic pump.



10. Place both inlet and outlet hose in the tank.

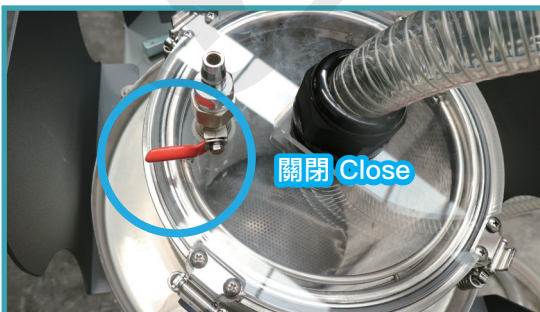

11.
Ensure that the relief valve is closed.

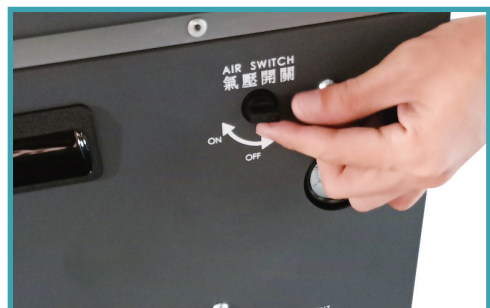

12.
Turn on the switch.

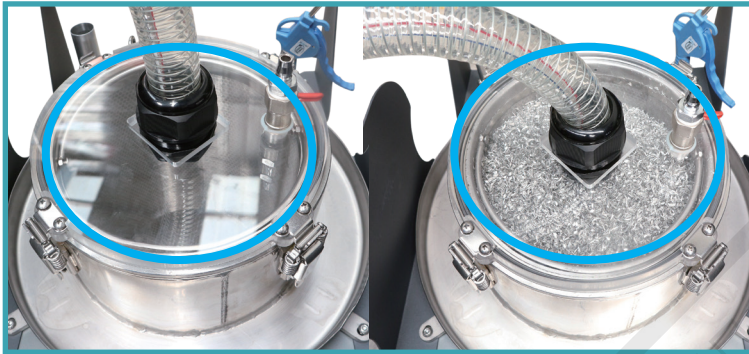

Bucket is full

1.

Visually check whether the swarf have filled the entire filter bucket.



2.

Open the pressure relief valve for about 30 seconds to dry it.
(After Opening the pressure relief valve, outside air will be absorbed to squeeze out excess water content from the filter bucket, thereby achieving the function of drying.)



3.

Turn off the air switch after drying is completed.



4.

Hold the filter bucket upside down, blow inward with an air gun to remove any remaining impurities, or wash the filter bucket with clean water.

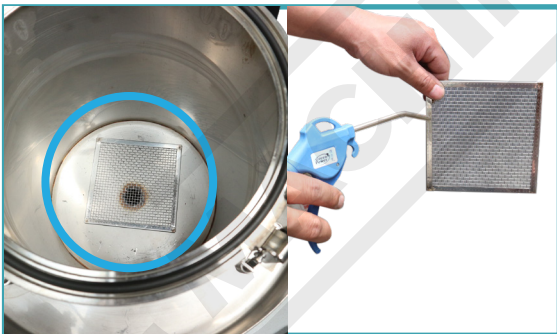

5.

Please note that there is a square mesh filter at the bottom of the filter bucket, which also needs regular cleaning with an air gun or water.

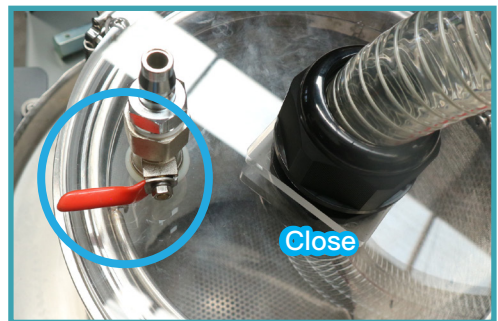

6.

After the cleaning is complete, close the pressure relief valve vent, then you can proceed with the next filtration process.

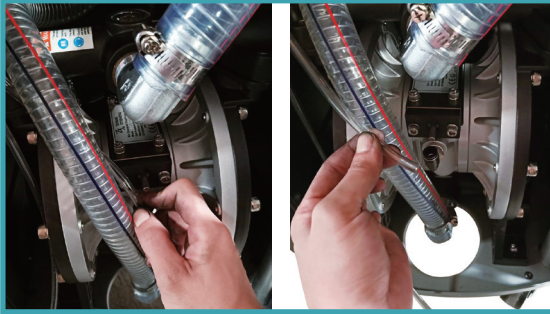

1.
Detach the air hose

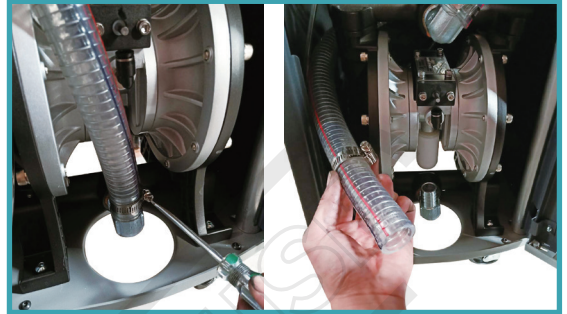

2.
Loosen the screw and the clamp to detach the outlet hose

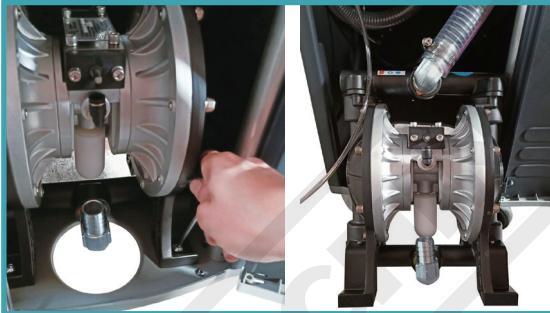

3.
Loosen and remove the bottom screws on each side to take off the pump

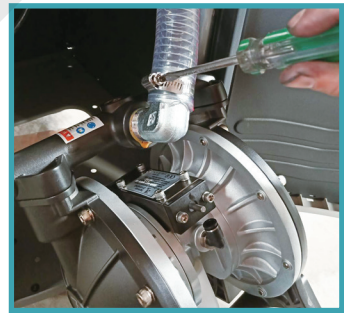

4.
Loosen the screw and the clamp to detach the inlet hose



5.
Replace the pneumatic pump

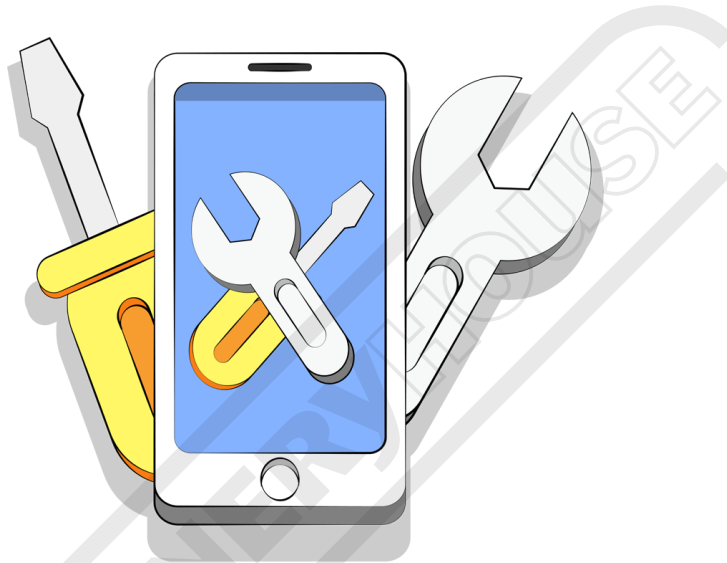

**For service for maintenance and repair,
please contact a local agent.**

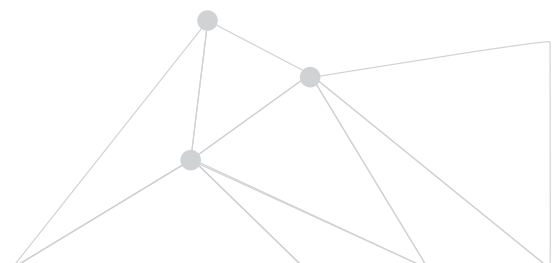



Imported by

HARE&FORBES
MACHINERYHOUSE

Australian Distributor

Hare & Forbes Machineryhouse
Sydney - Melbourne
Adelaide - Brisbane - Perth

Ph: 1300 202 200
www.machineryhouse.com.au