

WORKSHOP EQUIPMENT

BENCH DRILLS

BD-325

- 16mm drill capacity
- 2MT spindle
- 12 spindle speeds
- Swivel & tilt table
- 1hp, 240V motor

Order Code:
D590

\$352
RRP



BD-360

- 20mm drill capacity
- 2MT spindle
- 12 spindle speeds
- Swivel & tilt table
- 1hp, 240V motor
- Includes light

Order Code:
D594

\$451
RRP



DS-19 COMPACT POWER DRILL STAND

- 125mm throat
- 67mm stroke
- Rack & pinion up/down
- Suits hand drill with 38mm or 43mm collar

Hand drill not included

VAZEY DRILL PRESS TABLE

- Cast iron table
- V groove locates round pipe
- No clamps or jigs needed
- Suits 47mm bore

Drill not included

Order Code:
D585

\$110
RRP



Order Code:
D199

\$82.50
RRP



DPS-450 DRILL PRESS ROLLER SUPPORT

- 450mm wide rollers, 600 - 900mm length
- Adjustable clamp to suit Ø60-100mm column

Drill not included

Order Code:
W3425

\$66
RRP

PEDESTAL DRILLS

PD-325

- 16mm drill capacity
- 2MT spindle
- 12 spindle speeds
- Swivel & tilt table
- 1hp, 240V motor

Order Code:
D592

\$396
RRP



PD-440

- 28mm drill capacity
- 3MT spindle
- 12 spindle speeds
- Swivel & tilt table
- 1.5hp, 240V motor
- Includes light

PD-360

- 20mm drill capacity
- 2MT spindle
- 12 spindle speeds
- Swivel & tilt table
- 1hp, 240V motor
- Includes light

Order Code:
D596

\$495
RRP



PD-28 INDUSTRIAL

- 23mm drill capacity
- 2MT spindle
- 12 spindle speeds
- Swivel & tilt table
- 1hp, 240V motor

Order Code:
D160

\$1,155
RRP



PD-510

- 32mm drill capacity
- 4MT spindle
- 12 spindle speeds
- Table tilts 45°
- 2.4hp, 240V motor
- Includes light

Order Code:
D600

\$957
RRP



PD-35 INDUSTRIAL

- 31.5mm drill capacity
- 3MT spindle
- 9 spindle speeds
- Swivel & tilt table
- 1hp, 240V motor

Order Code:
D162

\$1,639
RRP



PUNCH SETS

ACP-155 AUTOMATIC CENTRE PUNCH

- Ø6mm hardened steel centre punch
- Ergonomically shaped plastic body
- Curved end to fit into palm
- Automatic single hand operation

T4I TOOLMASTER



Order Code:
P368
\$22
RRP

3 PIECE CENTRE PUNCH SET

- Point sizes 2.5, 5.5 & 7.0mm
- Knurled body for grip
- 150mm long for easy use
- Hardened and tempered

T4I TOOLMASTER



Order Code:
P367
\$19.80
RRP

6 PIECE PIN PUNCH SET

- Manufactured from Hi-grade Chrome Vanadium Steel
- Pin Punches (pin Ø x hex handle x length)
- Ø3 x 10 x 150mm
- Ø4 x 10 x 150mm
- Ø5 x 10 x 150mm
- Ø6 x 10 x 150mm
- Ø7 x 12 x 150mm
- Ø8 x 12 x 150mm



Order Code:
P365
\$19.80
RRP

PPS-7 HOLE PUNCH SET

- 1.2mm mild steel capacity
- 3/32", 1/8", 5/32", 3/16", 7/32", 1/4" & 9/32" punches & dies
- Includes plastic storage case

Order Code:
P112
\$60.50
RRP



Made in Taiwan



COLD CHISEL SET

COLD CHISEL SET

- Manufactured from Hi-grade Chrome Vanadium Steel
- 3 piece flat cold chisels (width x shaft hex x length)
- 9.9 x 8.0 x 138mm
- 12.7 x 11.0 x 150mm
- 16.2 x 12 x 165mm



Order Code:
P363
\$13.20
RRP

PUNCH & COLD CHISEL SET

- 14 Pieces
- Manufactured from Hi-grade Chrome Vanadium Steel
- 4pc Pin Punches (tip Ø x shaft hex x length)
 - Ø2.3 x 9.5 x 127mm
 - Ø3.0 x 9.5 x 127mm
 - Ø4.7 x 9.5 x 150mm
 - Ø6.5 x 12.6 x 150mm
- 5pc Flat Cold Chisels (width x shaft hex x length)
 - 12.8 x 9.45 x 150mm
 - 15.8 x 12.7 x 178mm
 - 19.0 x 18.2 x 177mm
 - 22.1 x 16.0 x 200mm
 - 25.5 x 19.0 x 215mm
- 4pc Tapered Punches (tip Ø x shaft hex x length)
 - 2.9 x 9.5 x 210mm
 - 4.0 x 12.7 x 225mm
 - 3.0 x 12.7 x 250mm
 - 9.6 x 16.0 x 250mm
- 1pc Center Punch (tip Ø x shaft hex x length)
 - 0 x 9.5 x 125mm

Order Code:
P364
\$66
RRP



WELDING CLAMPS

MWC-4 MICRO

- 0-7mm clamping
- 17mm throat depth
- Spring loaded opening
- Self aligning & serrated clamp faces



Order Code:
W112
\$31.90
RRP

BWC-4 BUTT

- Level adjusts between: 0-3mm either side
- Holds panels edge to edge with almost no gap - allowing full penetration of the weld



Order Code:
W113
\$42.35
RRP

PACK OF 4

PICK UP TOOLS

4 PIECE MAGNETIC PICK UP TOOL & INSPECTION MIRROR SET

- Magnetic tool extends 165 - 695mm
- Mirror extends 240mm to 920mm
- 1 x fixed head - 3.6kg magnetic lift
- 1 x fixed head - 2.3kg magnetic lift
- 1 x swivel head - 3.6kg magnetic lift

Order Code:
M0009
\$22
RRP



PICK UP TOOL WITH MAGNETIC HEAD

- 620mm long
- Ø14.8mm magnetic head
- 1 x LED Light



Order Code:
M0010
\$16.50
RRP

3 X LED LIGHTS TELESCOPIC

- 87 x 53mm head swivels 180°
- Adjustable length extends from 290 - 880mm



Order Code:
M0008
\$15.40
RRP

HEX KEY SETS

KEY SETS WITH T-BAR HANDLE

- Black phosphate finish on tips

HEX KEY

- 2, 2.5, 3, 4, 5, 6, 8, 10mm

\$82.50 (H820)

HEX KEY

- 5/64, 3/32, 1/8, 3/16, 5/32, 1/4, 5/16, 3/8"

\$82.50 (H821)

TORX KEY

- T10, T15, T20, T25, T27, T30, T40, T45, T50

\$82.50 (H822)

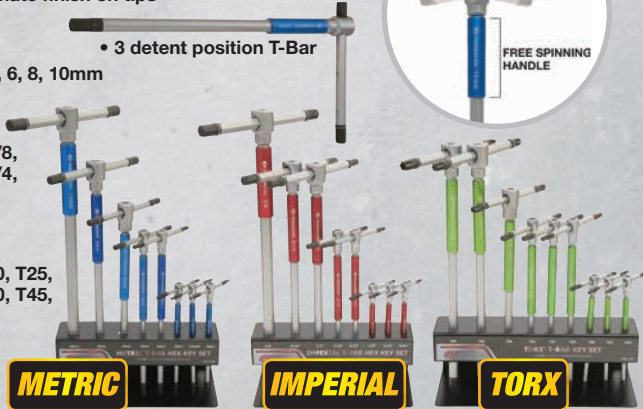

METRIC

IMPERIAL

TORX

DEBURRING TOOLS

SHEET METAL BURR

- Range 0-7.5mm
- Inc. 2 x Ø11.7mm blades
- Simultaneously removes burrs from both sides of sheet metal

Order Code: D063
\$24.20
RRP



PIPE/TUBE

- Suits internal & external
- Suitable for steel, stainless, copper
- Ø10 - Ø54mm capacity
- Aluminium knurled body

Order Code: D068
\$82.50
RRP

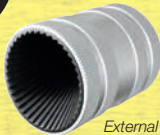

LEATHER BAGS

METALMASTER

RTSB-100 RECTANGLE LEATHER BAG

- 150 x 100mm
- Steel shot filled
- Hook & loop seal



Order Code: S214
\$60.50
RRP

RSBS-3 ROUND LEATHER BAGS

- Ø150, Ø254, Ø356mm bags
- Hook & loop seal
- Sand filled ready for use



Order Code: S210
\$132
RRP

RTSBS-2 RECTANGLE LEATHER BAGS

- 1 x 460 x 305mm bag
- 1 x 305 x 200mm bag
- Hook & loop seal
- Sand filled ready for use



Order Code: S212
\$121
RRP

FLEXIBLE BODY FILES

- 355mm file length

FBF-09T

- 9TPI mill cut

FBF-12T

- 12TPI mill cut



Order Code: F155
\$38.50
RRP

Order Code: F156
\$38.50
RRP

Order Code: F150
\$49.50
RRP

FBH-14 FLEXIBLE BODY FILE HOLDER

- Light weight aluminium body
- 355mm flexible spring steel base
- Right and left hand
- Convex or concave



SF-35M SLAPPING FILE - SECOND CUT

- 2nd cut medium file
- PVC handle for better grip
- Restoration repairs on car panels



Order Code: F160
\$44
RRP

HAMMERS

- Wooden hickory handle



Ø40mm soft faces, plastic, brass, nylon heads included

\$38.50 (H870)

Ø40mm dead blow nylon face

\$47.30 (H880)

Ø45mm soft faces, copper, steel, aluminium, pu, nylon heads included

\$78.65 (H875)

ABR-10M AUTO PANEL RESTORATION KIT - MASTER

- Genuine hickory handles
- 3 x Hammers (Door Skin + Flat Dresser + Fender & Panel Dinging)
- 3 x Dollies (Angle + High Crown + Anvil)
- 4 x Spoons (Angle & Flat Short Double + Drip Moulding + Light Dinging + Short Single)



Order Code: H887
\$297
RRP

UNIVERSAL - 23 PIECE

- 2 x De-burring tool holders
- 1 x Sheet metal de-burring tool
- 1 x 10 pack of HSS blades
- 1 x 20mm countersink blade
- 2 x Scraper blades
- 1 x "V" scraper
- 1 x Inverted "V" scraper
- 4 x Telescopic extensions
- Wrenches



Order Code: D065
\$110
RRP

CONTOUR GAUGES

- 126mm long (M966)
- 254mm long (M967)
- 45mm depth of contour
- Magnetic side



Order Code: M966
\$18.15
RRP

Order Code: M967
\$26.40
RRP

MALLETS

METALMASTER

WBH-2 HARD MAPLE WOOD BOSSING Mallet SET - RADIUS ENDS

- 1 x 75mm professional mallet
- 1 x 76mm standard mallet
- Tapered & radius end
- Hard Maple wood



Order Code: H892
\$77
RRP

NBH-2 NYLON BOSSING MALLETS - RADIUS ENDS

- High impact nylon with hickory wooden handle
- 1 x Professional mallet Ø75 to Ø16mm diameter ends
- 1 x Standard mallet Ø76 to Ø35mm diameter ends



Order Code: H890
\$88
RRP

NM-2 NYLON MALLETS - FLAT ENDS

- High impact nylon with hickory wooden handle
- 1 x Ø65 x 150 long mallet with flat ends
- 1 x Ø55 x 135 long mallet with flat ends



Order Code: H893
\$93.50
RRP

WM-2 HARD MAPLE WOOD Mallet SET - FLAT ENDS

- 1 x 60mm round mallet
- 1 x 76mm round mallet
- Flat end
- Hard Maple wood



Order Code: H894
\$82.50
RRP

ABR-7P AUTO PANEL RESTORATION KIT - PROFESSIONAL

- Drop forged, heat treated steel
- Precision ground & polished faces
- 1 x Pick + Finishing hammer
- 1 x Straight Pein + Finishing hammer
- 1 x Reverse Curve hammer
- 1 x Utility dolly • 1 x Curved dolly
- 1 x Heel dolly • 1 x Thin toe dolly



Order Code: H886
\$198
RRP

ABR-7 AUTO PANEL RESTORATION KIT - DIY

- Drop forged, heat treated steel
- Precision ground & polished faces
- 1 x Crown face with pick hammer
- 1 x Flat faced with straight pein hammer
- 1 x Double ended shrinking hammer
- 1 x Utility dolly • 1 x Curved dolly
- 1 x Heel dolly • 1 x Double ended hand dolly



Order Code: H885
\$108.90
RRP

AUTO PARTS WASHER

APW-22 BENCH MODEL

- 22 litre tank
- 113L/hr, 240V pump
- 398 x 298 x 210mm

Order Code:
A370

\$88
RRP



APW-76 - FLOOR MODEL

- 76 litre tank
- 180L/hr, 240V pump
- Safety fusible lid
- 700 x 480 x 250mm tank Size (LxWxD)

Order Code:
A368

\$176
RRP



APW-140 - FLOOR MODEL

- 140 litre tank
- 180L/hr 240V pump
- Safety link on lid
- 1060 x 520 x 270mm tank Size (LxWxD)

Order Code:
A374

\$253
RRP



WASHER ACCESSORIES

APW-BR BRUSH TO SUIT AUTO PARTS WASHERS

- 230mm brush
- 405mm flexible hose



Order Code:
A376

\$13.20
RRP

PARTS WASHER CONCENTRATE

- Non Flammable



5 Litres

Order Code:
A378

\$42.90
RRP



20 Litres

Order Code:
A377

\$143
RRP

WET & DRY VACUUM CLEANER

WDV-3P

- 1200W 240V motor
- Portable on wheels
- 30L stainless steel tank
- Include: brush, crevice tool, wet & dry floor nozzle

Order Code:
V504

\$209
RRP



FLOOR FAN & HOSE

AF-30 INDUSTRIAL AXIAL FLOW FLOOR FAN

- Ideal for fume extraction
- Ø300mm diameter
- 60 cubic m/min
- 520W 240V motor

Order Code:
F050

\$165
RRP



DH-30 - AIR DUCT HOSE

- Ø300mm x 5M
- PVC air duct

Order Code:
F051

\$60.50
RRP



SERVICE CARTS

PSC-2W PLASTIC SERVICE CART

- 250kg total load rating
- 2 trays (945 x 652 x 105mm)
- Includes storage tray handle
- 2 x swivel & 2 x fixed wheels

Order Code:
T749

\$253
RRP



SDC-2L STEEL SERVICE CART

- 705 x 370 x 835mm
- Key lockable table & drawers
- Ball bearing drawer slides
- Screwdriver holder tray
- Paper towel holder

Order Code:
T751

\$275
RRP



Order Code:
A385

\$363
RRP



ETT-1D STEEL GEARBOX & ENGINE TEAR DOWN TABLE

- 1200 x 640mm table top
- 875mm table height
- Fluid collection pan
- Lockable drawer

DRAWER

SSD-1 MOUNTS UNDER BENCH

- Food grade stainless steel
- 400 x 660 x 150mm (LxWxH)
- Ball bearing slides
- Suits SSB-20 & SSB-18WS stainless benches

Order Code:
F310

\$187
RRP



STAINLESS STEEL WORK BENCH

- Food grade stainless steel
- Reinforce bench top with 15mm MDF

SSB-CNR CORNER WORK BENCH

- 700 x 700 x 900mm (LxWxH)
- 100mm return splash back

Order Code:
F305

\$396
RRP



SSB-18WS

- 1800 x 700 x 900mm (LxWxH)
- 100mm return splash back

Order Code:
F298

\$473
RRP



SSB-20

- 2000 x 700 x 900mm (LxWxH)
- 78mm sub-frame bench top support

Order Code:
F280

\$517
RRP





INDUSTRIAL COUNTERSINK SETS

- 4 piece
- HSS M2 bright finish
- Cross hole type
- Range: Ø2-5, 5-10, 10-15, 15-20mm
- Angle 45°



Order Code:
D1051

\$71.50
RRP

- 6 piece
- HSS M2 bright finish
- 3 flute type
- Ranges: Ø1.5-6.3, 6.3-8.3, 8.3-10.4, 10.4-12.4, 12.4-16.5, 16.5-20.5mm



Order Code:
D1061

\$82.50
RRP

CENTRE DRILL SET

- Industrial quality
- HSS M2 bright finish
- No. 1, 2, 3, 4, 5



Order Code:
D508

\$47.30
RRP

SHEET METAL STEP DRILL SET

- 3 piece set
- HSS M2 bright finish
- Ø4-12 x 1mm, Ø6-20 x 2mm, Ø6-30 x 2mm



Order Code:
D1071

\$82.50
RRP

INDUSTRIAL DRILL SETS

- Precision ground flutes
- HSS M2 bright finish
- 135° split point centre

25 PIECE METRIC

1-13mm (x0.5mm)

\$99 (D1272)

29 PIECE IMPERIAL

1/16" - 1/2" (x1/64")

\$104.50 (D1282)



- Precision ground flutes
- HSS M2 bright finish

51 PIECE METRIC

1-6mm (x0.1mm)

Order Code:
D1285

\$126.50
RRP



2MT METRIC DRILL SET

- 100% HSS flute length
- Sizes: 14.5, 15, 16, 17, 18, 19, 20, 21, 22, 23mm

Order Code:
D122

\$209
RRP



REDUCED SHANK DRILL SETS

- High speed steel M2 grade 100% flute length
- 118° point angle

METRIC RANGE

- 13-25mm
- Shank Ø13mm

\$154 (D1171)

IMPERIAL RANGE

- 9/16" - 1"
- Shank Ø1/2"

\$154 (D1181)



8 PIECE SET

FEELER GAUGE

- 0.03 - 1.0 thickness range
- High grade tool steel
- Hardened tempered & polished



Order Code:
Q616

\$17.60
RRP

SCREW PITCH - THREAD GAUGE

- 28 x imperial threads
- 23 x metric threads



Order Code:
Q610

\$14.30
RRP

TELESCOPIC GAUGE SET

- 6 gauges
- 8 ~ 150mm capacity
- Spring loaded adjustable movement



Order Code:
Q618

\$49.50
RRP

ENGINEERS SQUARES

- Grade B 90° Inside/Outside



Code	Blade Length	PRICE
Q644	75mm	\$32.45
Q645	100mm	\$42.35
Q646	150mm	\$47.30
Q647	225mm	\$72.60

SCRIBERS

- Straight & 90° hardened steel tips
- Precision manufactured
- Knurled body for grip



Code	Type	PRICE
Q630	Double Ended Scriber	\$12.10
Q631	Pocket Pen Scriber	\$23.10

Measumax

"a new dimension in quality and value"

SCREW CUTTING GAUGE

- 4 thread forms
- 60° Metric & American threads
- 55° Whitworth/BSF threads



Order Code:
Q612

\$13.20
RRP

RADIUS GAUGES

- Internal / external radii.
- 1-7mm range (Q614)
- 7.5 - 15mm range (Q615)



Order Code:
Q614

\$26.40
RRP

Order Code:
Q615

\$36.30
RRP

DEGREE PROTRACTOR

- 0 - 180° range
- 0-100mm rule graduations
- 150mm rule length



Order Code:
Q601

\$29.70
RRP

STEEL RULES

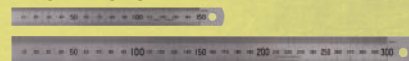

Code	Range	PRICE
Q620	150mm/6"	\$5.50
Q621	300mm/12"	\$11.00
Q622	600mm/24"	\$23.10
Q623	1000mm/40"	\$29.15

SPRING CALIPERS & DIVIDER

- 150mm size



Code	Type	PRICE
Q634	Divider	\$14.30
Q635	Inside	\$14.30
Q636	Outside	\$14.30

LOW VOLT HALOGEN & LED LAMPS



- (L283)
• Magnetic base
• Transformer included
- (L2814)
• 7 x LED
• 750 lux at 1 metre
• Transformer included
- (L284)
• Head swivels 310° & base 360°
• No transformer
• 12 Volt

Model	Type	Input Voltage	Watt	Code	PRICE
HL-35T	Flexible Lamp - Halogen	240V	35W	L283	\$93.50
HL-35LT	Flexible Lamp - 7 x LED	240V	7W	L2814	\$132.00
HL-55	Swivel & Pivot Arm - Halogen	12V	55W	L284	\$99.00
HL-55T	Swivel & Pivot Arm - Halogen	240V	55W	L285	\$143.00
HL-14LT	14W LED Work Light	240V	14W	L2816	\$143.00
HL-72L	14W LED Work Light with 2.25X Magnifier	240V	14W	L2821	\$187.00



- (L285)
• Head swivels 310° & base 360°
• Transformer included
• 240V
- (L2816)
• 300mm lamp head
• Dimmer control
• 500mm flexible arm
• Magnetic base
- (L2821)
• 14W - 5700K LED
• Dimmer control
• Swivel & pivoting arm
• Includes magnified lens

HBL-01 WORK LIGHT CLAMP BRACKET

- Clamps up to 45mm thickness
- 4 x M4 threaded holes
- 60mm x 60mm hole centres
- Made from 4mm steel plate
- Suits work lights: HL-35T, HL-35LT, HL-55T, HL-14LT

Order Code:
L2818

\$22
RRP

TURNING, PARTING, KNURLING TOOLS

HSS TURNING TOOL SET

- 4 piece
- 1 x R/H & 1 x L/H tool holder
- 1 x Straight tool holder
- 1 x 3/8" Boring bar
- 2 x 1/8" & 2 x 3/16" tool bits



Order Code:
L072

\$86.90
RRP

TM TOOLMASTER

PARTING TOOL HOLDER

- Case-hardened and ground
 - To suit tool steel blades
 - Positive locking ensures longer blade life
 - Designed to suit 16mm Tool Height
- NOTE: Parting blade not supplied
Uses Parting Blade L0007



Order Code:
L073

\$38.50
RRP

TM TOOLMASTER

PARTING TOOL HOLDER

- Case-hardened & ground
 - Positive locking ensures longer blade life
 - Designed to suit 12mm Tool Height
- NOTE: Parting blade not supplied
Uses Parting Blade L0007



Order Code:
L074

\$49.50
RRP

LATHE TURNING TOOL KIT

- 5-piece 10mm Tool kit
 - 4 x Turning tools
- Re-Order Inserts:
TCMT110204 (L062)
- 1 x Boring Bar
- Re-Order Inserts:
TCMT090204 (L0615)



Order Code:
L0055

\$99
RRP

LATHE TURNING TOOL KITS

- 1 x Right hand parting tool
- 1 x Threading tool
- 1 x right hand roughing turning tool
- 1 x left hand 90° turning tool
- 1 x right hand 90° turning tool
- 1 x straight profile turning tool
- 1 x right hand profile turning tool
- Complete with 1 x Insert per tool



Order Code:
L0099

\$176
RRP

KNURLING TOOL HOLDER KIT

- 12mm centre height at one end & 16mm at the other end
- Interchangeable heads with Medium, Fine & Straight knurls



TM TOOLMASTER

Centre Height	Head 1	Head 2	Head 3	CODE	PRICE
12 or 16mm	Medium 2 Wheels	Fine 2 Wheels	Straight 1 Wheel	L076	\$99.00

KNURLING TOOL HOLDER

- Diamond pattern



TM TOOLMASTER

Holder Size (LxWxH)	Knurl Size	Knurl Roller Qty.	Knurl Pitch	CODE	PRICE
123.6 x 16 x 16mm	19 x 9.5 x 6.3mm	2	Medium	L079	\$42.35
76 x 9.5 x 16mm	19 x 9.5 x 6.3mm	2	Medium	L080	\$71.50
139 x 9.5 x 22mm	16 x 8 x 6.3mm	6	Fine-Medium-Coarse	L070	\$95.70

LATHE TURNING TOOL HOLDERS

- Made from high grade steel
 - Case-hardened & ground
 - Available in straight (S), right (R) and left (L) hand shanks
- NOTE: HSS Tool bits not supplied.
Uses Tool Bit L0003

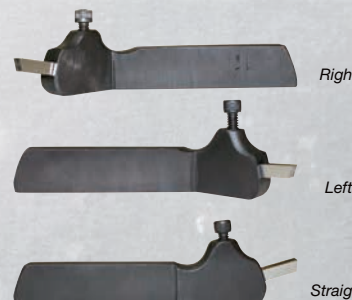

Shank Size (W x H)	Tool Bit Cap. (inch/mm)	Style	Hand	CODE	PRICE
9.5 x 22mm	1/4" / 6.3mm	American	Right	L070R	\$38.50
9.5 x 22mm	1/4" / 6.3mm	American	Left	L070L	\$38.50
9.5 x 22mm	1/4" / 6.3mm	American	Straight	L070S	\$38.50

BORING BARS, COOLANT HOSE & METAL TOOLS

BORING BAR SET - CARBIDE INSERT

- 3 x Boring bars in set (8, 10, 12mm)
- 3 x Inserts (Re-Order Inserts: L060)
- Aluminium case

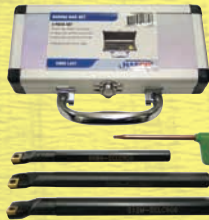

Order Code:
L431
\$169.40
RRP

BORING BAR SET - CARBIDE INSERT

- 4 x Boring bars in set (8, 10, 12, 16mm)
- 10 x inserts (Re-Order Inserts: L060)



Order Code:
L430
\$297
RRP

BORING BARS WITH HOLDERS

- Double-ended with 45° & 90° angular square holes
- Supplied fitted with screws & allen key
- NOTE: HSS Tool bits not supplied

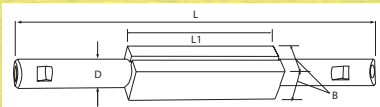

B	D	L	L1	Tool Bit Required	CODE	PRICE
1/2"	3/8"	4-1/2"	2-1/8"	1/8" (L0001)	L100	\$19.80
5/8"	7/16"	5-1/4"	2-1/2"	3/16" (L0002)	L101	\$22.00
3/4"	9/16"	6-3/4"	3"	1/4" (L0003)	L102	\$27.50
1"	3/4"	9"	3-3/4"	5/16" (L0004)	L103	\$38.50
1-1/4"	15/16"	11-1/2"	4-1/2"	3/8" (L0005)	L104	\$44.00

HIGH SPEED STEEL BITS

Tool Bit Size	No. Pieces	CODE	PRICE
1/8" SQ x 2-1/2" long	3 Piece	L0001	\$12.10
3/16" SQ x 2-1/2" long	3 Piece	L0002	\$13.75
1/4" SQ x 2-1/2" long	3 Piece	L0003	\$15.40
5/16" SQ x 2-1/2" long	3 Piece	L0004	\$18.15
3/8" SQ x 3" long	2 Piece	L0005	\$16.50
1/2" SQ x 4" long	1 Piece	L0006	\$18.15

TURNING TOOL KITS

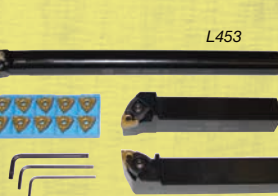

Package Code	L450
Turning Tool (Right Hand)	L015
Turning Tool (Left Hand)	L016
Boring Bar (Right Hand)	L021
Inserts (Pack of 10) Suits all tools TCMT110204	L062
PRICE	\$253

Package Code	L451
Turning Tool (Right Hand)	L017
Turning Tool (Left Hand)	L018
Boring Bar (Right Hand)	L022
Inserts (Pack of 10) Suit all tools TCMT110204	L062
PRICE	\$275

Package Code	L452
Turning Tool (Right Hand)	L039
Turning Tool (Left Hand)	L040
Boring Bar (Right Hand)	L415
Inserts (Pack of 10) WNMG080404	L0534
PRICE	\$352

Package Code	L453
Turning Tool (Right Hand)	L041
Turning Tool (Left Hand)	L042
Boring Bar (Right Hand)	L416
Inserts (Pack of 10) WNMG080404	L0534
PRICE	\$385

PARTING TOOL KITS

- 1 x Key insert remover
- 1 x Hex key



Package Code	L464
1 x 12mm Parting block	L027
1 x 26 x 2mm Parting blade	L468
2 x 2.2mm Parting inserts	L0512
PRICE	\$198

Package Code	L465
1 x 16mm Parting block	L028
1 x 26 x 2mm Parting blade	L468
2 x 2.2mm Parting inserts	L0512
PRICE	\$198

Package Code	L466
1 x 20mm Parting block	L029
1 x 26 x 3mm Parting blade	L469
2 x 3mm Parting inserts	L0513
PRICE	\$198

Package Code	L467
1 x 25mm Parting block	L030
1 x 32 x 3mm Parting blade	L4693
10 x 3mm Parting inserts	L0513
PRICE	\$330

THREADING TOOL KITS

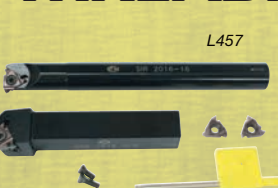

Package Code	L456
Internal Threading Tool	L036
External Threading Tool	L031
1 x 55° 16ER Insert	L055
1 x 55° 16IR Insert	L057
1 x 60° 16ER Insert	L056
1 x 60° 16IR Insert	L058
PRICE	\$209

Package Code	L457
Internal Threading Tool	L037
External Threading Tool	L032
1 x 55° 16ER Insert	L055
1 x 55° 16IR Insert	L057
1 x 60° 16ER Insert	L056
1 x 60° 16IR Insert	L058
PRICE	\$209

Package Code	L458
Internal Threading Tool	L038
External Threading Tool	L033
1 x 55° 16ER Insert	L055
1 x 55° 16IR Insert	L057
1 x 60° 16ER Insert	L056
1 x 60° 16IR Insert	L058
PRICE	\$264

Package Code	L459
Internal Threading Tool	L0385
External Threading Tool	L034
1 x 55° 16ER Insert	L055
1 x 55° 16IR Insert	L057
1 x 60° 16ER Insert	L056
1 x 60° 16IR Insert	L058
PRICE	\$275

FLEXIBLE COOLANT HOSE KITS

- Includes connector pliers, Y fitting, BSPT male & in-line valve, various nozzles & more
- Hose 150mm x 6 = 900mm

Internal Hose Diameter	CODE	PRICE
Ø1/4"	H165	\$72.60
Ø1/2"	H167	\$82.50



FACE MILL 90° - POSITIVE RAKE

- Suits 1/2" whitworth drawbars
- Insert tip not included



Cutter Approach Angle	Inserts Qty	CODE	PRICE
32mm x 90°	2	M528	\$88
50mm x 90°	3	M529	\$121

CHAMFER CUTTERS

Note: Inserts not included uses (L066)



Shank Size	Range	CODE	PRICE
20 x 65mm	Ø5 - Ø20mm	M501	\$66
25 x 120mm	Ø20 - Ø35mm	M502	\$99

KEYWAY BROACHES INDIVIDUAL

- HSS consisting of a broach & packing shim

METRIC

Size	CODE	PRICE
3mm	M4982	\$84.70
4mm	M4983	\$107.80
5mm	M4984	\$114.95
6mm	M4985	\$114.95
8mm	M4986	\$119.90
10mm	M4987	\$193.60
12mm	M4988	\$193.60

IMPERIAL

Size	CODE	PRICE
1/8"	M5002	\$84.70
3/16"	M5003	\$107.80
1/4"	M5004	\$114.95
5/16"	M5005	\$119.90
3/8"	M5006	\$119.90
1/2"	M5008	\$193.60

KEYWAY BROACH SETS

- Supplied in wooden case
- High-speed steel broach set consisting of broaches, bushes & packing shims



Type	Broach Size	CODE	PRICE
Metric	4, 5, 6, 8mm	M498	\$495
Imperial	1/8, 3/16, 1/4, 3/8"	M500	\$495



BoxTac®

ASSORTMENT PACK

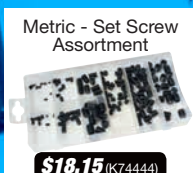

METRIC - O-RING ASSORTMENT
\$30.25 (K74150)

IMPERIAL (SAE) - O-RING ASSORTMENT
\$30.25 (K74146)



Specials from:

Prices valid for Nov - Dec 2019 Jan 2020